



Meteor

Series *Explosion proof*

Explosion proof fixture suitable for hazardous areas, Zone 1,21 and Zone 2,22 and Groups IIA, IIB, IIC. Applicable to all industrial hazardous environments exposed to gas and/or dust explosion danger.

Meteor

LED INDUSTRIAL EXPLOSION-PROOF FIXTURE

Benchmark in the field of industrial explosion-proof lighting

IP66

140LM/W

20/40/60/75W



Grey and Yellow Coating optional

ATEX

Certified

II 2G Ex eb mb IIC T6 Gb

II 2D Ex tb IIIC T(110°C) Db



ATEX-fixture certified according to the ATEX directives. High energy efficiency (140 lm/W). Water resistant (IP66) and shock proof (IK10). Easy installation and linkable in series through WAGO-connectors with through-put wiring and dual stainless steel glands.

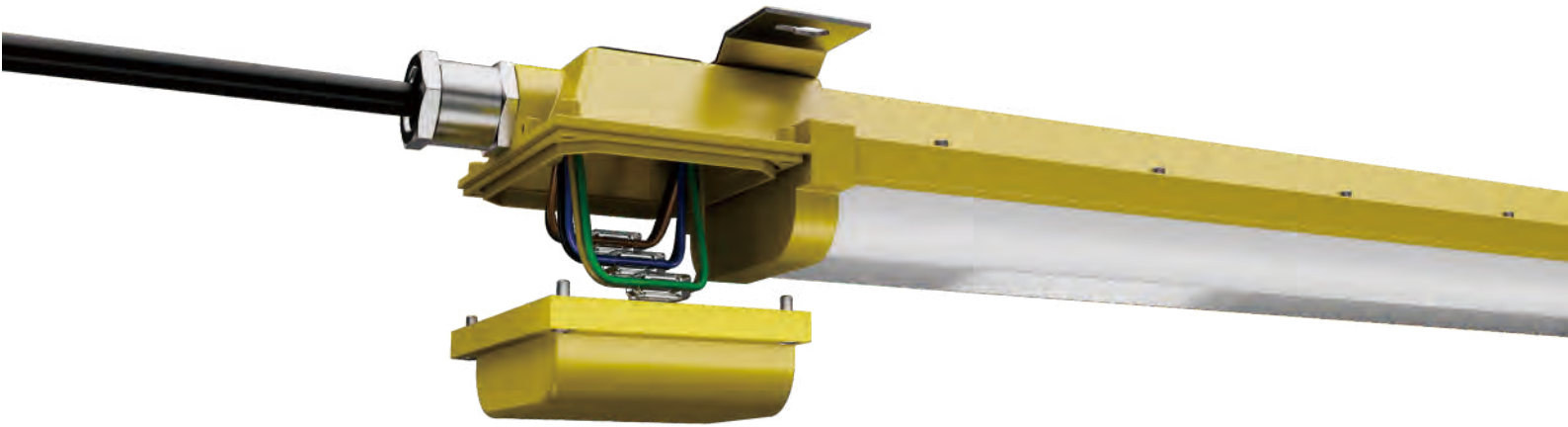

Wago connectors

Easy Rewiring
Cost Saving

*3x 2.5mm² wire-through cabling.
Stainless steel gland on both sides.
Linkable in series to save installation
time and cost.*

Linkable in Series

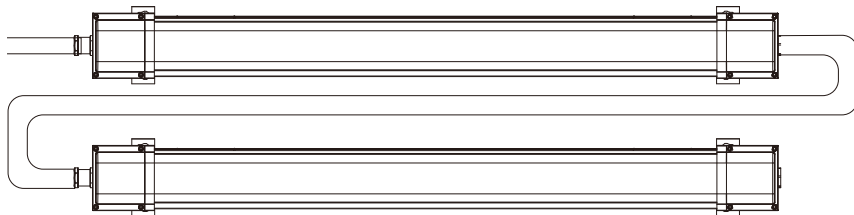

IP66

Water resistant due to strong sealing performance with special anti-aging silicone sealing ring. High and low temperature resistance. Manufactured with high-precision machining technology.

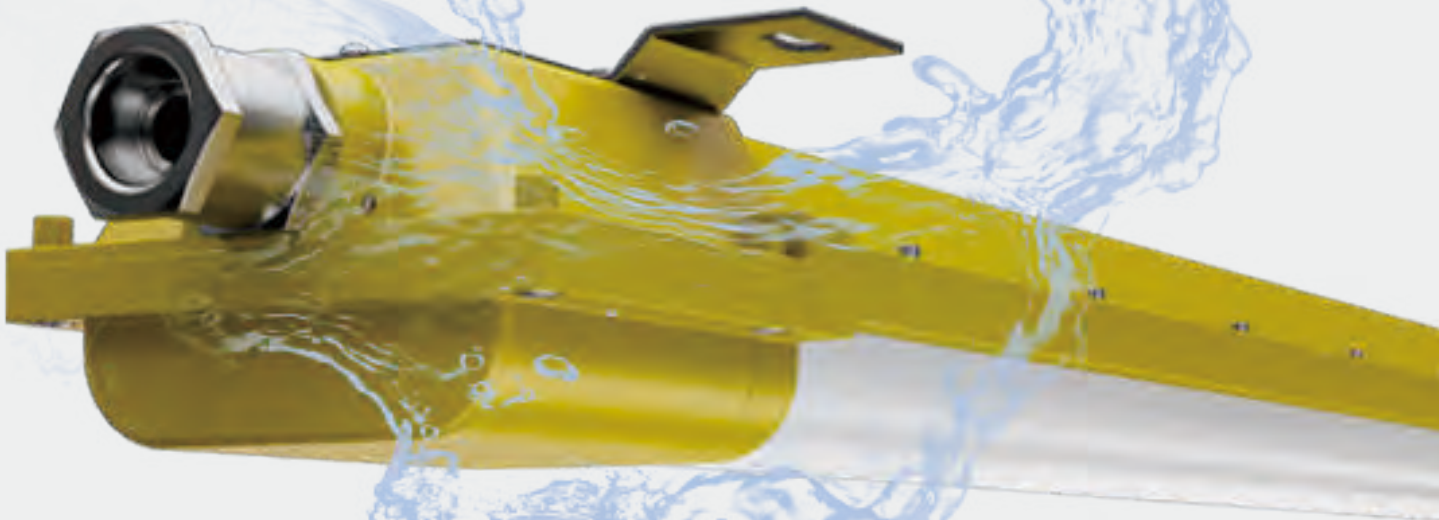

WF2 Anti-corrosive

The surface of the fixture is treated by high-voltage electrostatic spraying, resulting in high corrosion resistance and rust prevention. Anti-corrosion level Wf2.

Excellent Heat Conductivity

A6063 alloy aluminum material



Structural heat dissipation design

- ◇ *The radiator consists of high pressure alloy diecast A6063 aluminum*
- ◇ *Designed for fast heat conduction and optimal heat-dissipation
Super strong and sturdy high impact body (IK70)*
- ◇ *Silicone seals with high thermal conductivity of 3.0.*

Examples of mounting

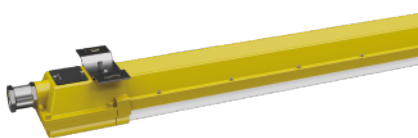
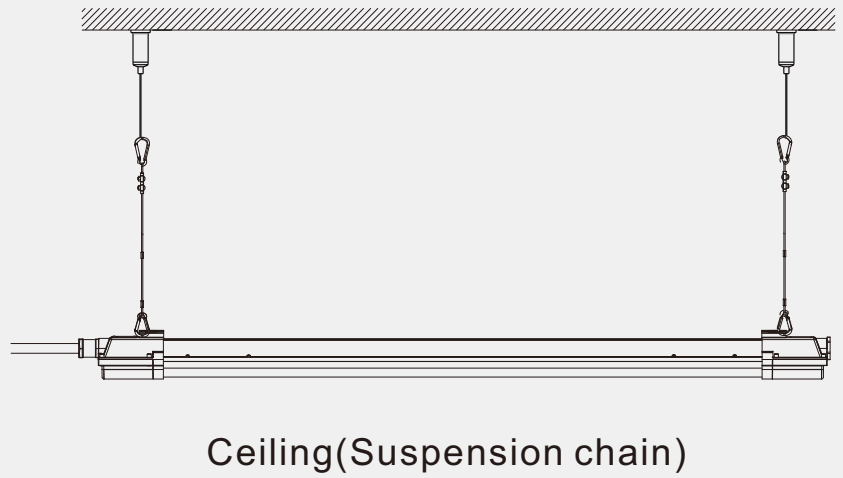
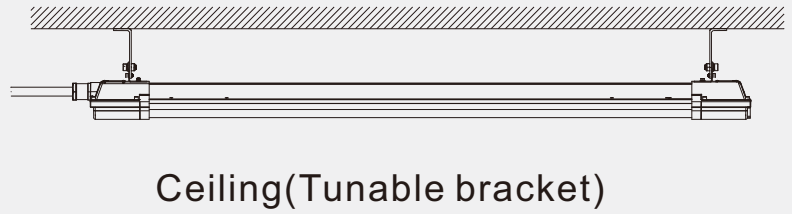
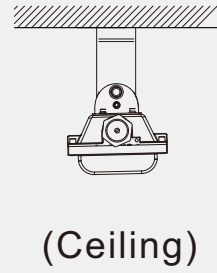
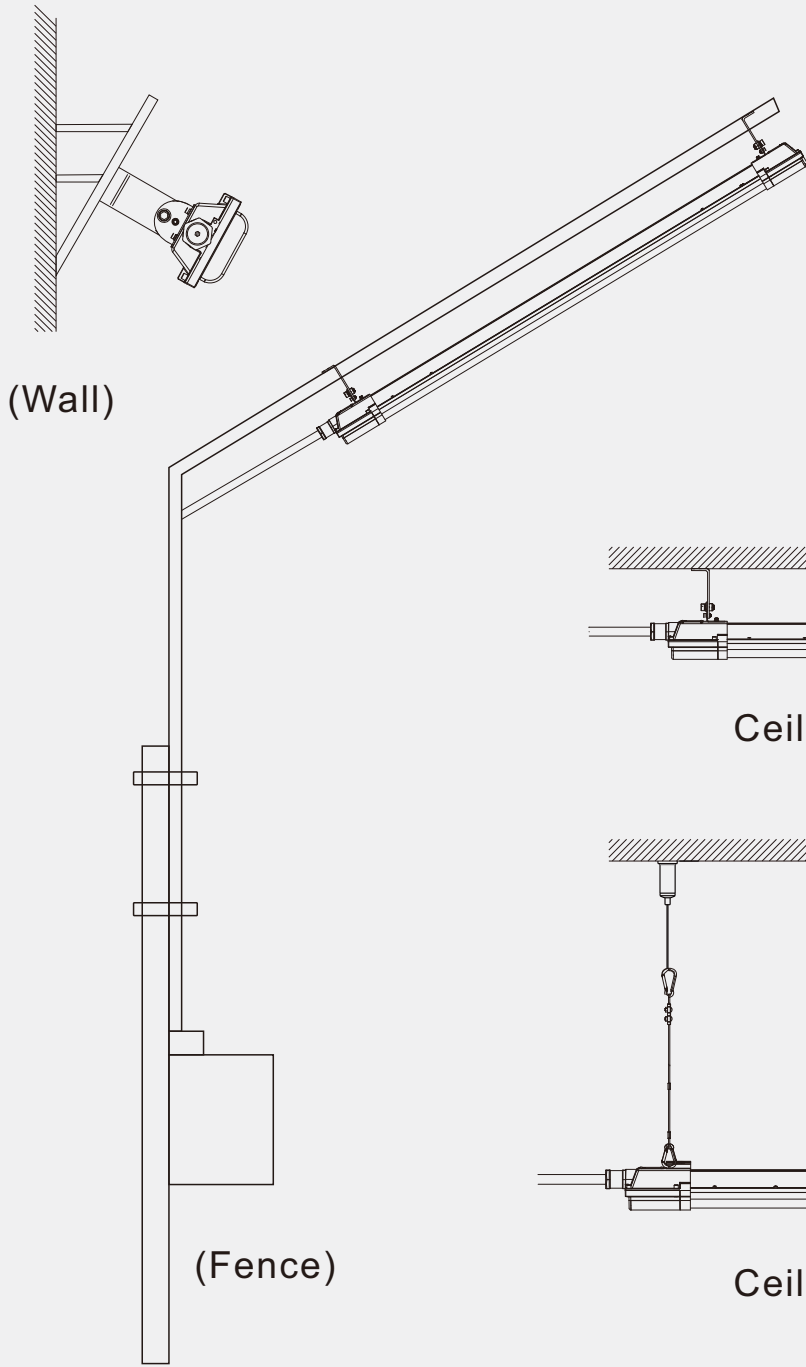

Fixed bracket



Tunable bracket



Hanging chain

Application

Zone 1 Zone 2
Zone 21 Zone 22

Applied to oil fields, oil refineries, offshore oil platform, power plants, gas stations, oil tanks, wharf tunnels, pumping stations, main- and substations, military bases, etc.

Hazardous Locations: Zone 1, 21 and 2, 22; Groups IIA, IIB, IIC.



Chemical Industry

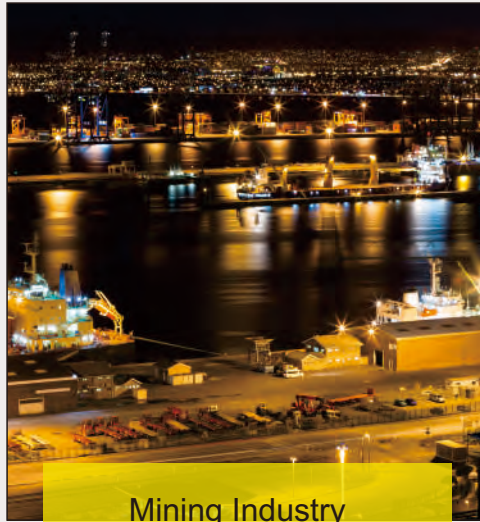

Mining Industry

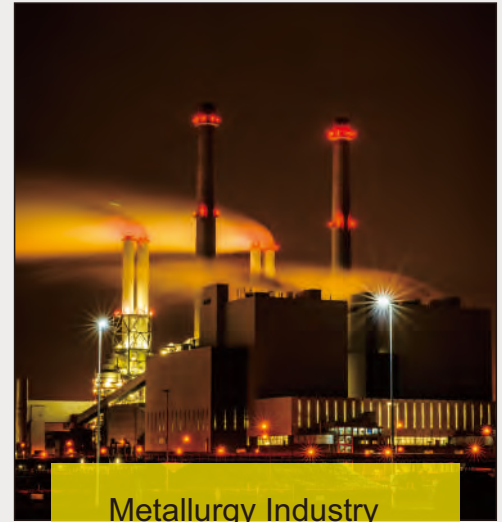

Metallurgy Industry



Industrial manufacturing



Tank Industry



Steel Industry



Ship Industry



Warehouse



Industrial factories

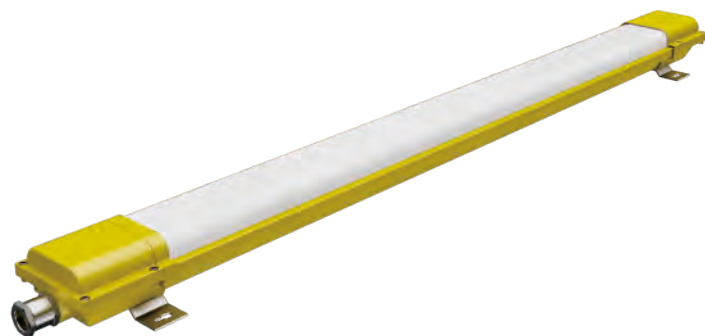

Features

Housing: Pure Aluminum A6063
 Thermal Conductivity: 226 W/m·K
 Led: Bridgelux
 CRI: Ra>80
 SDCM: <6
 Power Factor: >0.95
 THD: <15
 Driver: Tridonic Driver
 Driver Efficiency: >92%
 Protection: OTP, OCP, OVP, SCP
 Surge Protection: 4KV
 Waterproof: IP66
 Impact Test: IK10
 Corrosion Proof: WF2
 Electrical: 220-240V, 50/60Hz
 Operating Temperature: -25~45°C
 TM21: L90B10>50,000H
 Lifetime: 50,000H

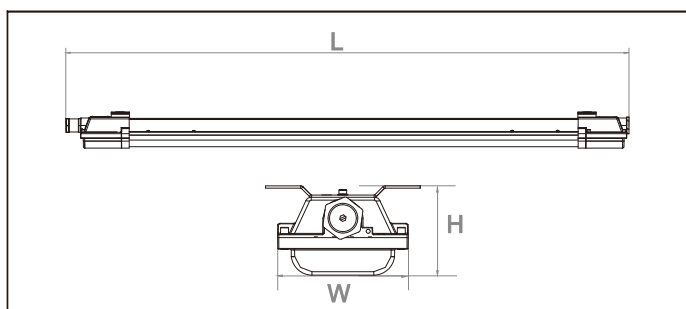

Optional

ZigBee PWM DALI, 0/1~10V

Optical options:

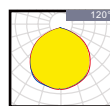

Model	Watt	Voltage	Lumen	CRI	IP	Dimension
U-M-20	20W	220~240	2800LM	>80	IP66	599*135*78mm
U-M-40	40W	220~240	5600LM	>80	IP66	599*135*78mm
U-M-40	40W	220~240	5600LM	>80	IP66	1199*135*78mm
U-M-60	60W	220~240	8400LM	>80	IP66	1199*135*78mm
U-M-75	75W	220~240	10500LM	>80	IP66	1199*135*78mm

Packing

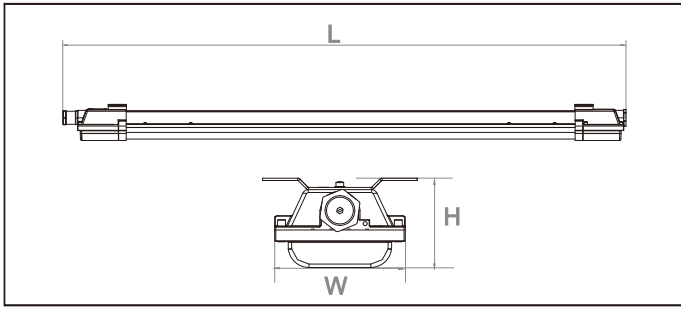

Model	L*W*H (MM)	Inner Carton(mm)			QTY/ INNER CTN	Outer Carton(mm)			QTY/ Outer CTN	NW/CTW	GW/CTW
U-M-20	599*135*78	/	/	/	/	755	160	115	1	3.26	4.04
U-M-40	599*135*78	/	/	/	/	755	160	115	1	3.26	4.04
U-M-40	1199*135*78	/	/	/	/	1355	160	115	1	4.20	4.95
U-M-60	1199*135*78	/	/	/	/	1355	160	115	1	4.20	4.95
U-M-75	1199*135*78	/	/	/	/	1355	160	115	1	4.20	4.95